

McKee and Associates
Architecture and Interior Design

Addendum

No. SIX Date: 8/28/08

**Project: ADDITIONS AND RENOVATIONS TO
DALRAIDA ELEMENTARY SCHOOL
FOR
THE MONTGOMERY COUNTY BOARD OF EDUCATION
MONTGOMERY, ALABAMA**

Project No. 07-138

A6.1 GENERAL

- A. The following changes and/or substitutions to the plans and specifications are hereby made a part of same and are incorporated in full force as part of the contract.
- B. Bidders shall acknowledge receipt of this Addendum in writing on his Proposal Form.
- C. The Owner has elected to hold a second Pre-Bid Conference for General Contractors. This shall be held at McKee & Associates on Friday, August 29, 2008 at 9:00 AM.
- D. The Contractor shall include TCU CONSULTING SERVICES on the "General Liability Insurance" policy as an additional insured.
- E. The General Contractor shall be required to submit a submittal log with the expected due dates for each item. This shall be sent to TCU CONSULTING SERVICES no later than 30 days after the "NOTICE TO PROCEED".
- F. Clarification and Additional Information:
 - a) Concrete Testing: Every truck shall be tested for the continuous footings.
 - b) Carmichael Engineering shall be used for all IBC Special Inspections. The General Contractor shall be responsible for the coordination of these inspections. Disregard all notes on plans and the drawings that the General Contractor to employ Independent Laboratory.

McKee and Associates

- c) No Building Permit shall be required for this project.
- d) The Owner shall pay all water and sewer impact and tap fees. General Contractor shall coordinate.
- e) The General Contractor shall provide an updated schedule with every pay request.
- f) The schedule as provided by the General Contractor shall include all required inspections.
- g) All General Contractors bidding this project shall include with their bid proposal a list of all major subcontractors and suppliers.
- h) **The Bid Date for this project shall remain as stated "Thursday, September 4, 2008 at 2:00 PM".**

A6.2 SPECIFICATIONS

- A. The following manufactures are hereby approved subject to the Plans and Specifications:

Section 15920

Johnson Controls, Inc. – Facility Building Automation Direct Digital Control Systems

Section 07530

CertainTeed Commercial Roofing Systems

A6.3 DRAWINGS

- A. Clarification: Interactive White Boards shall be furnished and installed by the Owner.
- B. On **Sheet A-1.6**, delete reference to MDF Core at all cabinets. Provide cabinets construction as specified in Section 12304, Laminate Clad Casework.
- C. Refer to **Sheet C-1:**
 - a) Near the intersection of Dalraida Road and Johnstown Drive, change the wording "relocate" to "remove" at the 36" pine.
 - b) Remove existing grease trap completely.
 - c) Completely remove the 12" storm line under the new building.

D. Refer to **Sheet C-2:**

- a) Add Note 4 – “See Architectural for Sequence of Construction”.
- b) Clarification: The domestic water meter exists.
- c) Refer to the existing fire hydrant near the siren pole. Relocate this fire hydrant 55 feet to the east.

E. Refer to Item 47, identifying the Teachers Cabinets in Room R103, and Item 48 identifying the Teachers Cabinets in Room R203.

F. Refer to Item 49, showing revisions to Doors R124A and R124B.

END OF ADDENDUM SIX

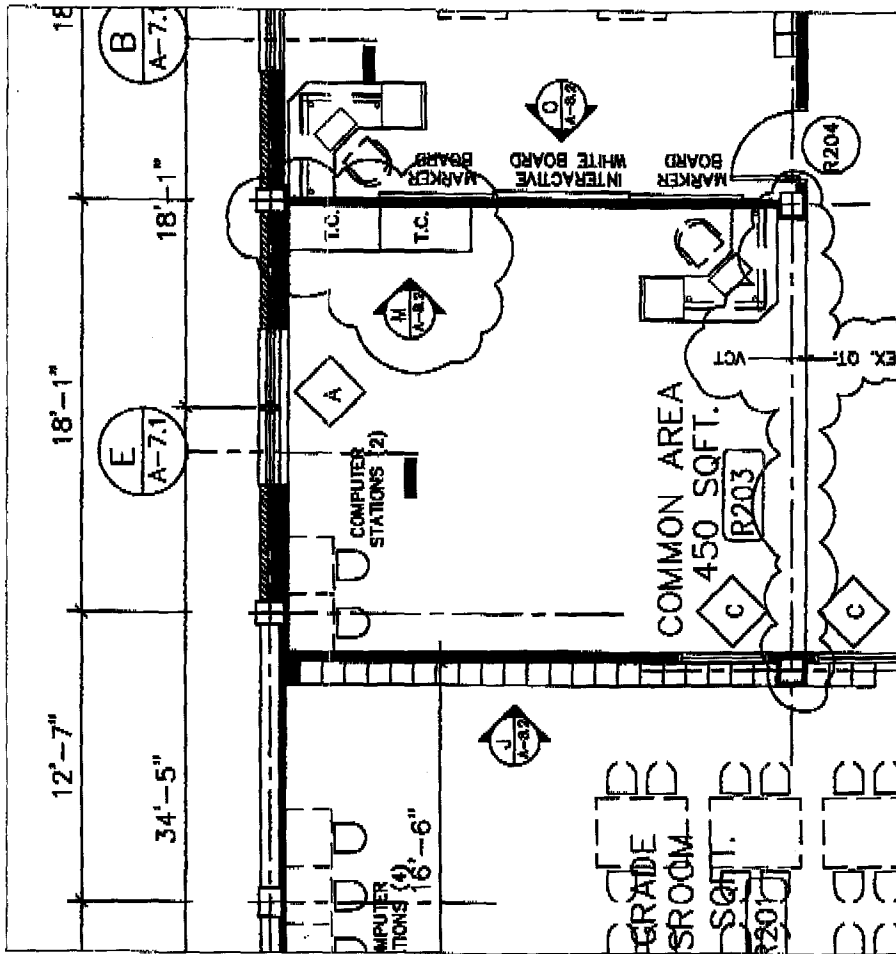

ITEM # 48

R123A	3'-0"	7'-0"	$\frac{1}{3/4}$ "	FLUSH WOOD SOLID CORE	B	STAIN	HOLLOW METAL
R123B	3'-0"	7'-0"	$\frac{1}{3/4}$ "	FLUSH WOOD SOLID CORE	B	STAIN	HOLLOW METAL
R124A	PAIR 3'-0"	7'-0"	$\frac{1}{3/4}$ "	HOLLOW METAL	B	PAINT	HOLLOW METAL
R124B	PAIR 3'-0"	7'-0"	$\frac{1}{3/4}$ "	HOLLOW METAL	B	PAINT	HOLLOW METAL
R126A	3'-0"	7'-0"	$\frac{1}{3/4}$ "	FLUSH WOOD SOLID CORE	C	STAIN	HOLLOW METAL
R126B	3'-0"	7'-0"	$\frac{1}{3/4}$ "	FLUSH WOOD SOLID CORE	C	STAIN	HOLLOW METAL

ITEM 49